

GLEASON® PowerTrak

LX Type Model PT26LX-AC Parts List

ITEM	DESCRIPTION	PART NO.
1	Outer Link	046538
2	Inner Link—2.00 radius	04162804
	Inner Link—2.50 radius	04162806
	Inner Link—2.75 radius	04807501
	Inner Link—4.53 radius	04807502
	Inner Link—5.63 radius	04807503
3	Pin—PT26L Trak Splice*	044792
4	Aluminum Channel—4.00" lg.	02705701
	Aluminum Channel—6.00" lg.	02705702
	Aluminum Channel—8.00" lg.	02705703
	Aluminum Channel—10.00" lg.	02705704
	Aluminum Channel—12.00" lg.	02705705
5	Pan Head Locking Screw	047390
6	L.H. Mounting Bracket Kit <i>Includes Pins and E-Rings</i>	043384
7	R.H. Mounting Bracket Kit <i>Includes Pins and E-Rings</i>	043383

* Includes (6) pins and (6) E-rings. Used for splicing or repair. Original equipment has riveted construction.

SIDE CHAIN ASSEMBLY	
Includes items 1 and 2, riveted together to form length in feet specified, rounded up to next full link.	
Qty. 1 = one 1 ft. section for one side only.	
L.H. and R.H. chains identical.	
RADIUS	PART NO.
2.00	04916701
2.50	04916702
2.75	04916703
4.53	04916704
5.63	04916705

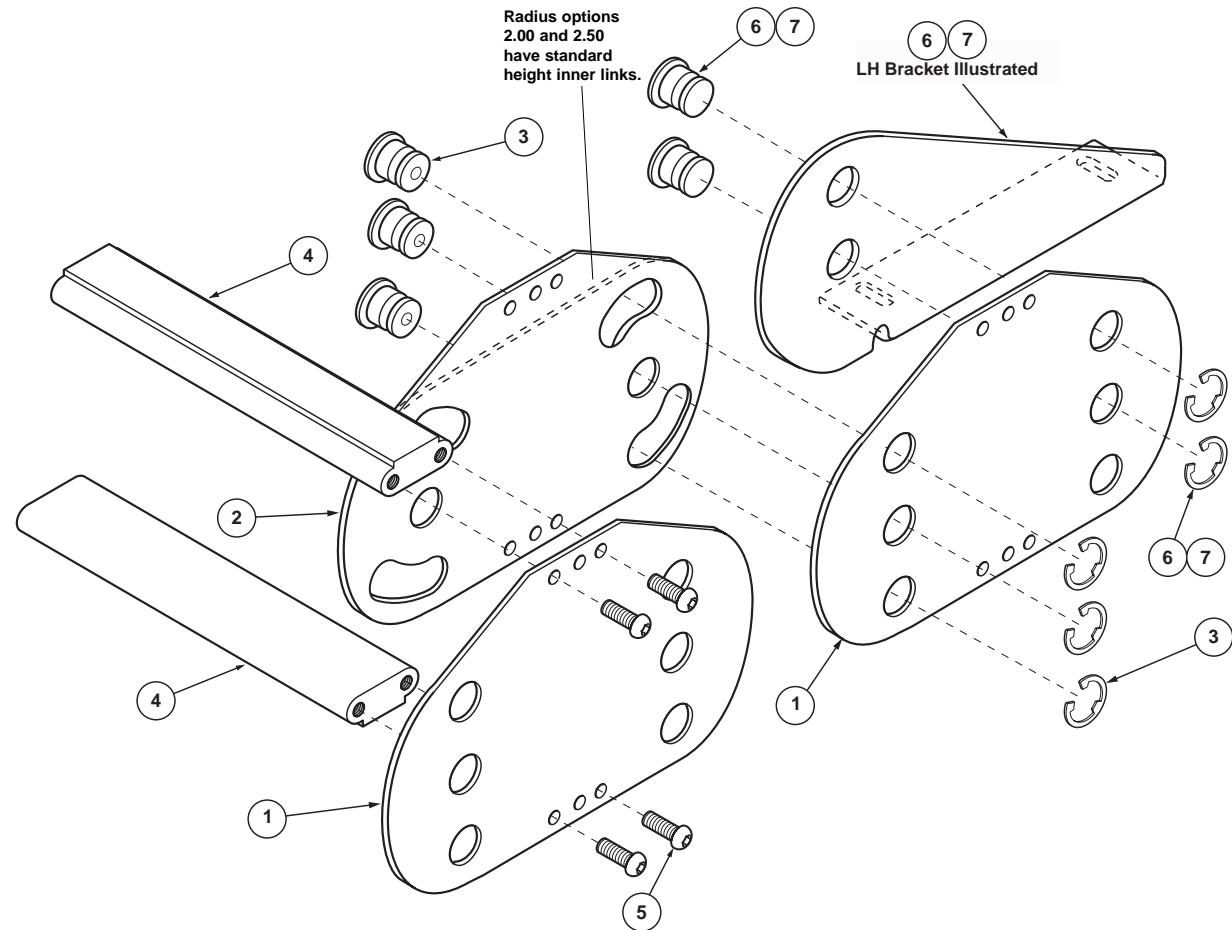

GLEASON REEL CORP.
P.O. Box 26 • 600 South Clark St.
Mayville, WI 53050-0026
Phone 920-387-4120 • Fax 920-387-4189