

GLEASON TRACK • MASTER™

SERIES C50-F

For FLAT Cable

- FLAT CLAMP DESIGN
- 1.25" DIA. PRECISION BALL BEARING STEEL WHEELS STANDARD

- MAX SADDLE DIAMETER = 6.31"
- MAX TROLLEY LOAD = 80 lbs.
- TRAVEL SPEEDS UP TO 350 fpm
- ACCELERATION—Consult us if over 2.0 ft/sec²
- MAX TRAVEL = 250 ft.—Consult us if greater

Standard Trolley Design

- 1.25" Dia. precision ball bearing wheels
- Bearings are pre-lubricated for life
- Tow trolley included as standard
- Hardware is zinc plated
- Orange baked polyester powder finish
- Includes heavy duty bumpers
- Cable Clamp allows cable package height to vary up to 0.12"

GALVANIZED C-RAIL

FLAT CABLE CLAMP

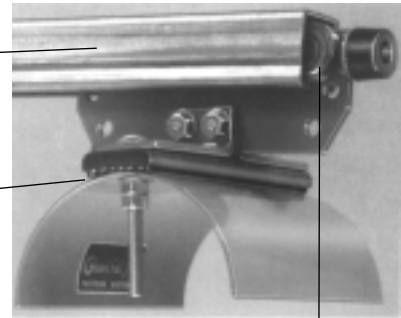

S

STEEL WHEELS
Bronze available

Model Number Explained

For STANDARD DESIGN, specific model numbers are on the following pages.

TYPE	CLAMP STYLE	SADDLE DIAMETER	WINDOW HEIGHT	WINDOW WIDTH	ITEM		Standard Hardware HARDWARE MATERIAL	Standard Wheels** WHEEL MATERIAL
#C50	F	03	08	01	I	-	Z - ZINC PLATED	S STEEL
Chosen by computer						Options you select	Hardware Option	Wheel Option
							S STAINLESS	B BRONZE

* Example above is for INTERMEDIATE TROLLEY (I) Use same option changes (at right) for other components as required.

**Not applicable to end clamps

Option Design Features

CODE	OPTION
<input checked="" type="checkbox"/> B	BRONZE ANTI-SPARK WHEELS w/ BRONZE BEARINGS (De-rate maximum trolley load by 50% for bronze wheels)
<input checked="" type="checkbox"/> S	STAINLESS STEEL HARDWARE
<input type="checkbox"/>	OTHER FINISHES AVAILABLE – PLEASE CONTACT US
<input type="checkbox"/>	FACTORY PRE-ASSEMBLY ON SHIPPING FRAME

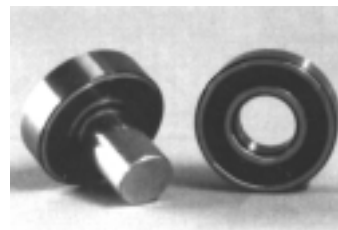

STANDARD STEEL WHEELS

Bronze Anti-Spark Wheels
Optional

Track Hardware

See detail pages at back of catalog

- RAIL TRACK SECTIONS
- RAIL COUPLER ASSEMBLIES
- VINYL END CAPS
- RAIL HANGER ASSEMBLIES
- RAIL ENDSTOP ASSEMBLIES

Accessories

See detail pages at back of catalog

- TOW CHAINS
- HOSE - GENERAL PURPOSE or HYDRAULIC
- JUNCTION BOX(ES)
- CABLE - ROUND OR FLAT
- TERMINAL BLOCKS
- TY-WRAPS
- CABLE CLAMPS—FLAT DESIGN
- CABLE GLANDS FOR SINGLE CABLES OR GROUPS

Series C50-F Components & Dimensions

FLAT CLAMP DESIGN for FLAT CABLE

All dimensions in inches unless otherwise specified.

End Clamp *One Required*

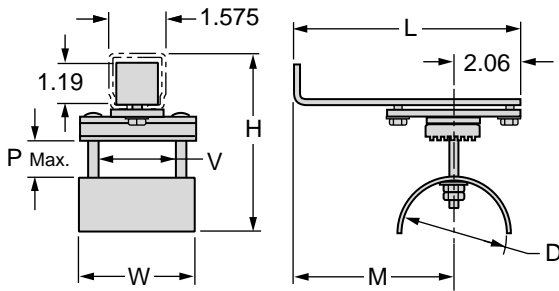

Model Number w/ Std Hardware & Wheels	Saddle Radius R	Saddle Dia. D	Window Height P	Window Width V	Overall Length L	Overall Width W	Top of Track H	Saddle Locator M
C50-F03-0801E-Z	1.56	3.12	0.81	1.88	6.62	3.19	4.94	4.56
C50-F03-0802E-Z	1.56	3.12	0.81	2.62	6.62	3.94	4.94	4.56
C50-F03-0805E-Z	1.56	3.12	0.81	5.00	6.62	6.31	4.94	4.56
C50-F03-1501E-Z	1.56	3.12	1.50	1.88	6.62	3.19	5.63	4.56
C50-F03-1502E-Z	1.56	3.12	1.50	2.62	6.62	3.94	5.63	4.56
C50-F03-1505E-Z	1.56	3.12	1.50	5.00	6.62	6.31	5.63	4.56
C50-F03-2301E-Z	1.56	3.12	2.30	1.88	6.62	3.19	6.43	4.56
C50-F03-2302E-Z	1.56	3.12	2.30	2.62	6.62	3.94	6.43	4.56
C50-F03-2305E-Z	1.56	3.12	2.30	5.00	6.62	6.31	6.43	4.56
C50-F04-0601E-Z	2.47	4.94	0.62	1.88	7.53	3.19	5.75	5.47
C50-F04-0602E-Z	2.47	4.94	0.62	2.62	7.53	3.94	5.75	5.47
C50-F04-0605E-Z	2.47	4.94	0.62	5.00	7.53	6.31	5.75	5.47
C50-F04-1301E-Z	2.47	4.94	1.38	1.88	7.53	3.19	6.43	5.47
C50-F04-1302E-Z	2.47	4.94	1.38	2.62	7.53	3.94	6.43	5.47
C50-F04-1305E-Z	2.47	4.94	1.38	5.00	7.53	6.31	6.43	5.47
C50-F04-2301E-Z	2.47	4.94	2.30	1.88	7.53	3.19	7.35	5.47
C50-F04-2302E-Z	2.47	4.94	2.30	2.62	7.53	3.94	7.35	5.47
C50-F04-2305E-Z	2.47	4.94	2.30	5.00	7.53	6.31	7.35	5.47
C50-F06-0702E-Z	3.16	6.31	0.70	2.62	8.22	3.94	6.44	6.16
C50-F06-0705E-Z	3.16	6.31	0.70	5.00	8.22	6.31	6.44	6.16
C50-F06-0706E-Z	3.16	6.31	0.70	6.56	8.22	7.88	6.44	6.16
C50-F06-1702E-Z	3.16	6.31	1.70	2.62	8.22	3.94	7.44	6.16
C50-F06-1705E-Z	3.16	6.31	1.70	5.00	8.22	6.31	7.44	6.16
C50-F06-1706E-Z	3.16	6.31	1.70	6.56	8.22	7.88	7.44	6.16
C50-F06-2202E-Z	3.16	6.31	2.25	2.62	8.22	3.94	7.98	6.16
C50-F06-2205E-Z	3.16	6.31	2.25	5.00	8.22	6.31	7.98	6.16
C50-F06-2206E-Z	3.16	6.31	2.25	6.56	8.22	7.88	7.98	6.16

Intermediate Trolley *Quantity as Required*

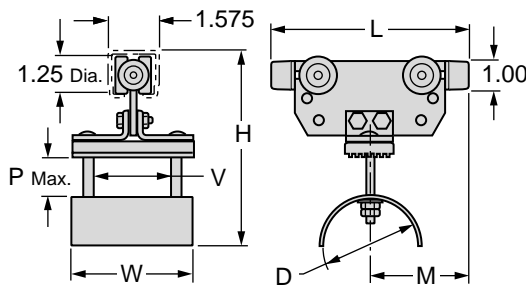

Model Number w/ Std Hardware & Wheels	Saddle Radius R	Saddle Dia. D	Window Height P	Window Width V	Overall Length L	Overall Width W	Top of Track H	Saddle Locator M
C50-F03-0801I-Z-S	1.56	3.12	0.81	1.88	4.94	3.19	6.12	2.47
C50-F03-0802I-Z-S	1.56	3.12	0.81	2.62	4.94	3.94	6.12	2.47
C50-F03-0805I-Z-S	1.56	3.12	0.81	5.00	4.94	6.31	6.12	2.47
C50-F03-1501I-Z-S	1.56	3.12	1.50	1.88	6.31	3.19	6.72	3.16
C50-F03-1502I-Z-S	1.56	3.12	1.50	2.62	6.31	3.94	6.72	3.16
C50-F03-1505I-Z-S	1.56	3.12	1.50	5.00	6.31	6.31	6.72	3.16
C50-F03-2301I-Z-S	1.56	3.12	2.30	1.88	7.88	3.19	7.52	3.94
C50-F03-2302I-Z-S	1.56	3.12	2.30	2.62	7.88	3.94	7.52	3.94
C50-F03-2305I-Z-S	1.56	3.12	2.30	5.00	7.88	6.31	7.52	3.94
C50-F04-0601I-Z-S	2.47	4.94	0.62	1.88	6.31	3.19	6.72	2.47
C50-F04-0602I-Z-S	2.47	4.94	0.62	2.62	6.31	3.94	6.72	2.47
C50-F04-0605I-Z-S	2.47	4.94	0.62	5.00	6.31	6.31	6.72	2.47
C50-F04-1301I-Z-S	2.47	4.94	1.38	1.88	7.88	3.19	7.52	3.16
C50-F04-1302I-Z-S	2.47	4.94	1.38	2.62	7.88	3.94	7.52	3.16
C50-F04-1305I-Z-S	2.47	4.94	1.38	5.00	7.88	6.31	7.52	3.16
C50-F04-2301I-Z-S	2.47	4.94	2.30	1.88	9.88	3.19	8.52	3.94
C50-F04-2302I-Z-S	2.47	4.94	2.30	2.62	9.88	3.94	8.52	3.94
C50-F04-2305I-Z-S	2.47	4.94	2.30	5.00	9.88	6.31	8.52	3.94
C50-F06-0702I-Z-S	3.16	6.31	0.70	2.62	7.88	3.94	7.52	2.47
C50-F06-0705I-Z-S	3.16	6.31	0.70	5.00	7.88	6.31	7.52	2.47
C50-F06-0706I-Z-S	3.16	6.31	0.70	6.56	7.88	7.88	7.52	2.47
C50-F06-1702I-Z-S	3.16	6.31	1.70	2.62	9.88	3.94	8.52	3.16
C50-F06-1705I-Z-S	3.16	6.31	1.70	5.00	9.88	6.31	8.52	3.16
C50-F06-1706I-Z-S	3.16	6.31	1.70	6.56	9.88	7.88	8.52	3.16
C50-F06-2202I-Z-S	3.16	6.31	2.25	2.62	11.00	3.94	9.12	3.94
C50-F06-2205I-Z-S	3.16	6.31	2.25	5.00	11.00	6.31	9.12	3.94
C50-F06-2206I-Z-S	3.16	6.31	2.25	6.56	11.00	7.88	9.12	3.94

Series C50-F Components & Dimensions, con't.

FLAT CLAMP DESIGN for FLAT CABLE

All dimensions in inches unless otherwise specified.

Tow Trolley *Standard...One Required*

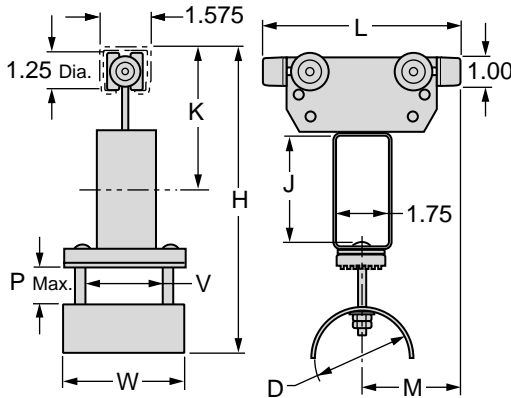

Model Number w/ Std Hardware & Wheels	Saddle Radius R	Saddle Dia. D	Window Height P	Window Width V	Overall Length L	Overall Width W	Top of Track H	Saddle Locator M	Tow Arm Height	Tow Arm Locator
C50-F03-0801T-Z	1.56	3.12	0.81	1.88	7.88	3.19	8.82	3.94	2.56	4.38
C50-F03-0802T-Z	1.56	3.12	0.81	2.62	7.88	3.94	9.12	3.94	2.69	4.47
C50-F03-0805T-Z	1.56	3.12	0.81	5.00	7.88	6.31	9.12	3.94	2.69	4.47
C50-F03-1501T-Z	1.56	3.12	1.50	1.88	7.88	3.19	9.52	3.94	2.56	4.38
C50-F03-1502T-Z	1.56	3.12	1.50	2.62	7.88	3.94	9.82	3.94	2.69	4.47
C50-F03-1505T-Z	1.56	3.12	1.50	5.00	7.88	6.31	9.82	3.94	2.69	4.47
C50-F03-2301T-Z	1.56	3.12	2.30	1.88	7.88	3.19	10.32	3.94	2.56	4.38
C50-F03-2302T-Z	1.56	3.12	2.30	2.62	7.88	3.94	10.62	3.94	2.69	4.47
C50-F03-2305T-Z	1.56	3.12	2.30	5.00	7.88	6.31	10.62	3.94	2.69	4.47
C50-F04-0601T-Z	2.47	4.94	0.62	1.88	7.88	3.19	10.22	3.94	2.56	4.29
C50-F04-0602T-Z	2.47	4.94	0.62	2.62	7.88	3.94	10.52	3.94	2.69	4.38
C50-F04-0605T-Z	2.47	4.94	0.62	5.00	7.88	6.31	10.52	3.94	2.69	4.38
C50-F04-1301T-Z	2.47	4.94	1.38	1.88	7.88	3.19	10.22	3.94	2.56	4.29
C50-F04-1302T-Z	2.47	4.94	1.38	2.62	7.88	3.94	10.52	3.94	2.69	4.38
C50-F04-1305T-Z	2.47	4.94	1.38	5.00	7.88	6.31	10.52	3.94	2.69	4.38
C50-F04-2301T-Z	2.47	4.94	2.30	1.88	9.88	3.19	13.42	4.94	4.25	5.56
C50-F04-2302T-Z	2.47	4.94	2.30	2.62	9.88	3.94	13.92	4.94	4.62	5.82
C50-F04-2305T-Z	2.47	4.94	2.30	5.00	9.88	6.31	13.92	4.94	4.62	5.82
C50-F06-0702T-Z	3.16	6.31	0.70	2.62	7.88	3.94	10.52	3.94	2.69	4.38
C50-F06-0705T-Z	3.16	6.31	0.70	5.00	7.88	6.31	10.52	3.94	2.69	4.38
C50-F06-0706T-Z	3.16	6.31	0.70	6.56	7.88	7.88	10.52	3.94	2.69	4.38
C50-F06-1702T-Z	3.16	6.31	1.70	2.62	9.88	3.94	14.02	4.94	4.62	5.91
C50-F06-1705T-Z	3.16	6.31	1.70	5.00	9.88	6.31	14.02	4.94	4.62	5.91
C50-F06-1706T-Z	3.16	6.31	1.70	6.56	9.88	7.88	14.02	4.94	4.62	5.91
C50-F06-2202T-Z	3.16	6.31	2.25	2.62	11.00	3.94	14.62	5.50	4.62	5.96
C50-F06-2205T-Z	3.16	6.31	2.25	5.00	11.00	6.31	14.62	5.50	4.62	5.96
C50-F06-2206T-Z	3.16	6.31	2.25	6.56	11.00	7.88	14.62	5.50	4.62	5.96

Control Unit Trolley *Optional... Replaces Tow Trolley*

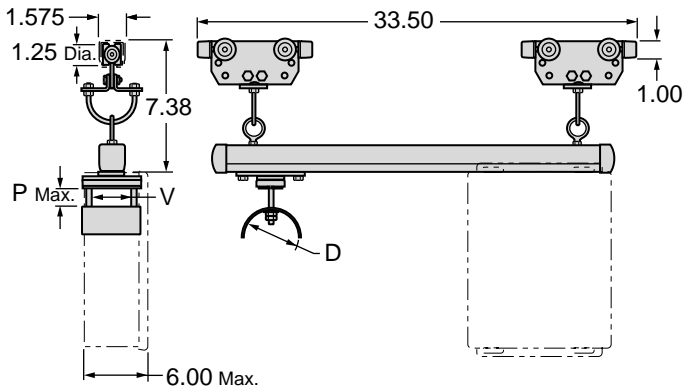

Model Number w/ Std Hardware & Wheels	Saddle Radius R	Saddle Dia. D	Window Height P	Window Width V
C50-F03-0801U-Z-S	1.56	3.12	0.81	1.88
C50-F03-0802U-Z-S	1.56	3.12	0.81	2.62
C50-F03-0805U-Z-S	1.56	3.12	0.81	5.00
C50-F03-1501U-Z-S	1.56	3.12	1.50	1.88
C50-F03-1502U-Z-S	1.56	3.12	1.50	2.62
C50-F03-1505U-Z-S	1.56	3.12	1.50	5.00
C50-F03-2301U-Z-S	1.56	3.12	2.30	1.88
C50-F03-2302U-Z-S	1.56	3.12	2.30	2.62
C50-F03-2305U-Z-S	1.56	3.12	2.30	5.00
C50-F04-0601U-Z-S	2.47	4.94	0.62	1.88
C50-F04-0602U-Z-S	2.47	4.94	0.62	2.62
C50-F04-0605U-Z-S	2.47	4.94	0.62	5.00
C50-F04-1301U-Z-S	2.47	4.94	1.38	1.88
C50-F04-1302U-Z-S	2.47	4.94	1.38	2.62
C50-F04-1305U-Z-S	2.47	4.94	1.38	5.00
C50-F04-2301U-Z-S	2.47	4.94	2.30	1.88
C50-F04-2302U-Z-S	2.47	4.94	2.30	2.62
C50-F04-2305U-Z-S	2.47	4.94	2.30	5.00
C50-F06-0702U-Z-S	3.16	6.31	0.70	2.62
C50-F06-0705U-Z-S	3.16	6.31	0.70	5.00
C50-F06-0706U-Z-S	3.16	6.31	0.70	6.56
C50-F06-1702U-Z-S	3.16	6.31	1.70	2.62
C50-F06-1705U-Z-S	3.16	6.31	1.70	5.00
C50-F06-1706U-Z-S	3.16	6.31	1.70	6.56
C50-F06-2202U-Z-S	3.16	6.31	2.25	2.62
C50-F06-2205U-Z-S	3.16	6.31	2.25	5.00
C50-F06-2206U-Z-S	3.16	6.31	2.25	6.56

Note: Rail Mounted Junction Boxes are available.
See "Accessories" section at back of catalog.